

MODELS: <b>ERC17</b>	<b>ERC36</b>	<b>ERC36B</b>	<b>COOLERS: Glass Door Merchandiser</b>
----------------------	--------------	---------------	---



ERC 36 B



ERC 36



ERC 17

### General Strengths

- ✓ **Sanitation.** The interior cabinet is built with rounded corners (extensive radius for easy cleaning). Quick ability to take off shelves and slides for interior cleaning. Each cabinet has a drain at the bottom of the unit. When cleaning the unit make sure the drain hose is routed to a floor drain.
- ✓ **Doors.** Self-closing door system with permanent pressure. Stay open feature included when door remains open after 95 degrees. All doors include triple chamber door gaskets, easy to remove and snap in. Doors are field reversible.
- ✓ **Control systems.** Higher precision in managing temperature settings. Greater ability to adjust of temperature ranges as per the end user's requirement.
- ✓ **100% Tested.** All condenser units are tested 100%, in helium chambers to refrigerant leak detections.
- ✓ **Certified.** AENOR audited and certified by internationally recognized firm. ISO 9001:2008 (Quality); ISO 14001:2004 (Environmental); OSHAS 18001:2007 (Prevention and Worker Safety). Audited and Certified by **INTERTEK** for compliance with UL 471 and NSF 7.
- ✓ **Lighting.** LED lighting in the canopy and cabinet sides reduces the energy consumption by 80% and 90% compared to a traditional bulb. Provides a much better light quality.

MODELS	Dimensions (mm)			Nº Doors	Nº Shelves	Chamber Volume (L)	Gross Volume (L)	Regimen Temp. (°C)	Ref.	Ref. Weight (gr.)	Net Weight (Kg.)
	Width	Depth	High								
ERC17	620	595	1085	1	2	175	400	+4 °C / +8°C	R404A	260	70
ERC36	620	595	1870	1	4	355	690	+4 °C / +8°C	R404A	330	113
ERC36B	620	595	1870	1	4	355	690	+4 °C / +8°C	R404A	330	113

WE RESERVE THE RIGHT TO CHANGE SPECIFICATIONS WITHOUT PRIOR NOTICE

<b>MODELS:</b> ERC17	ERC36	ERC36B	<b>COOLERS:</b> Glass Door Merchandiser
----------------------	-------	--------	--

### STANDARD FEATURES

➤ **Exterior**

- Exterior of PVC-coated steel,
- Completely injected compact structure,

➤ **Interior**

- Interior of PVC-coated steel,
- LED lighting,
- Illuminated frontal panel,
- Drain inside the cabinet.

➤ **Insulation**

- Insulation by free CFC's polyurethane foam high-pressure injected with density 40 Kg/m<sup>3</sup>,
- Zero ODP and Low GWP.

➤ **Doors**

- Doors with double glass (6-10-4),
- Clear of door 735x540 mm (ERC17) and 1450x540 mm (ERC36).

➤ **Shelves**

- (2) interior shelves (ERC17),
- (4) interior shelves (ERC36),
- Interior shelves of 525x350 mm,
- Guides and shelves easy to take off for cleaning.

➤ **Refrigeration**

- Temperature and defrost regulated by a digital controller,
- System of Ventilated Condensation,
- System of Forced Evaporation,
- Evaporation tray of stainless steel,
- Evaporator coil coated with anti-corrosion material,
- Climate class 4 (30°C, 55HR).

➤ **Electrical**

- Electrical connection: 220 V / 1 ph / 50 Hz



**OPTIONAL**

- Wire shelf (ERC17),
- Wire shelf (ERC36),
- Tropicalized to 43°,
- Customizable,
- Electrical connection 220 V / 1 ph / 60 Hz.,
- Electrical connection 115 V / 1 ph / 60 Hz.

MODELS	Dimensions Palletizing (mm)			Crated Weight (Kg.)	Power (W)	Comp. (HP)	Cooling Power (W to -10°C)	Cons. (kWh/24h)	Inten. (A)	Level Noise (dB)	Container 20'/40'/40'HC	Trailer
	Width	Depth	High									
ERC17	715	700	1245	82	290	1/8	286	2,8	1,85	56,3	24 / 48 / 96	114
ERC36	715	700	1955	128	575	1/4	577	4,1	1,85	58,4	24 / 48 / 48	57
ERC36B	715	700	1955	128	575	1/4	577	4,1	1,85	58,4	24 / 48 / 48	57

WE RESERVE THE RIGHT TO CHANGE SPECIFICATIONS WITHOUT PRIOR NOTICE

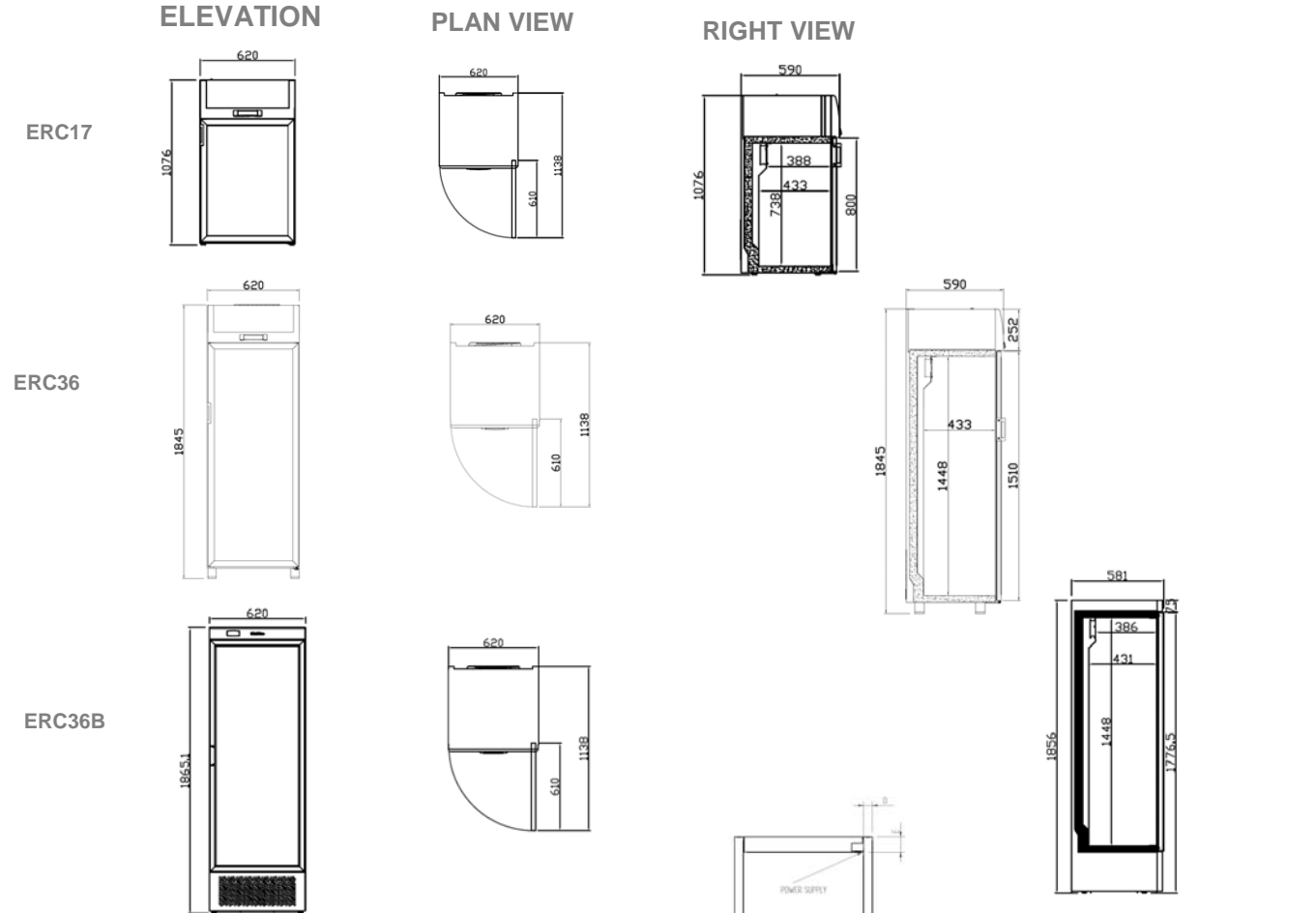
**MODELS: ERC17    ERC36    ERC36B    COOLERS: Glass Door Merchandiser**
**PLAN VIEW**

**CONNECTIONS**

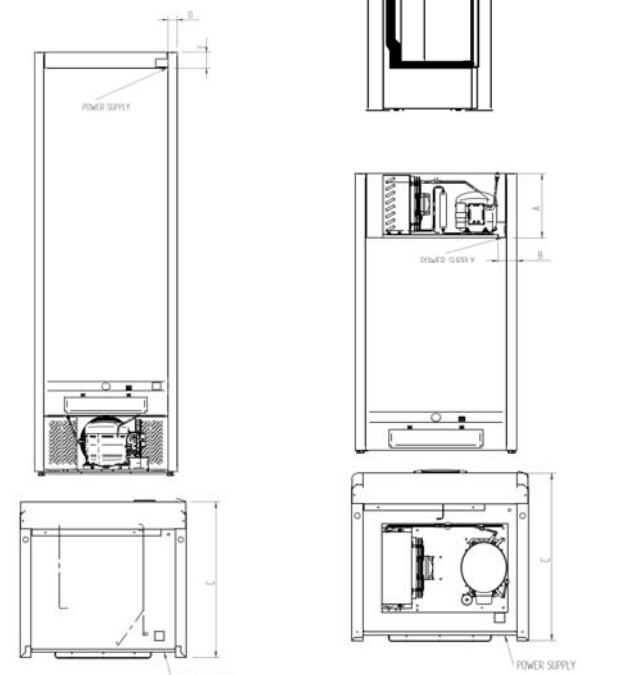
MODELS	A (mm)	B (mm)	C (mm)	D (mm)	E (mm)
ERC17	248	72	595	-	-
ERC36	248	72	595	-	-
ERC36B	-	-	595	40,5	70



WE RESERVE THE RIGHT TO CHANGE SPECIFICATIONS WITHOUT PRIOR NOTICE

Review: 01    Date: 26/07/2013